

THE DAYTON ART INSTITUTE

Art Changes
Lives **Live it**

Live it at The Dayton Art Institute!

UPPER LEVEL GALLERIES

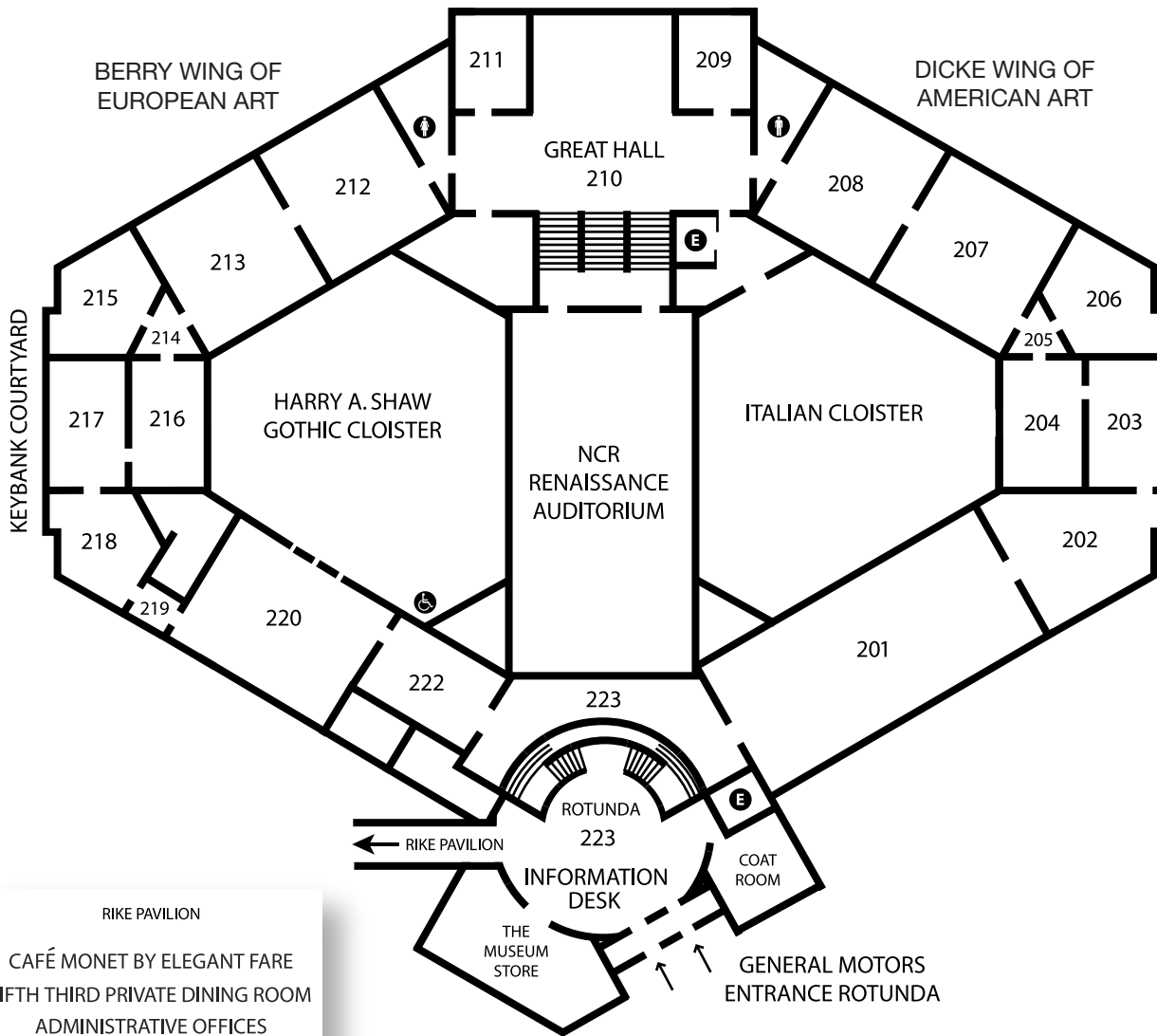

- 201 Contemporary Art
- 202 Katy Dicke Gallery of After 1945 American Art
- 203 Janet S. Dicke Gallery of Early 20th Century American Modernism
- 204 J. Bradford Tillson Gallery of Early 20th Century American Modernism
- 205 American Decorative Arts
- 206 Jennifer St. Clair Dicke Gallery of Early 20th Century American Art
- 207 Dayton Power and Light Company Gallery of 19th Century American Art
- 208 Warren and Mary Webster Gallery of Colonial & Early American Art
- 209 Special Projects
- 210 Great Hall/Sculpture Court
- 211 Ancient Art
- 212 Bieser Family Gallery of Late 19th Century French Art
- 213 Gray Gallery of 18th Century European Art
- 214 European Decorative Arts
- 215 17th Century Baroque Art in Flanders and France
- 216 The Epstein Family Gallery of 17th Century Dutch Art
- 217 17th Century Baroque Painting in Italy
- 218 Kresge Foundation Gallery of 16th and 17th Century European Art
- 219 European Prints and Drawings
- 220 Late Medieval and Renaissance Art
- 222 Carl H. & Irene K. Dicke Gallery
- 223 General Motors Entrance Rotunda

RIKE PAVILION

CAFÉ MONET BY ELEGANT FARE
FIFTH THIRD PRIVATE DINING ROOM
ADMINISTRATIVE OFFICES
MEAD LEARNING CENTER
CHASE EDUCATOR RESOURCE CENTER

- REST ROOMS
- ELEVATOR
- WHEELCHAIR ACCESS

PHOTOGRAPHY Non-commercial photography is permitted of the museum's permanent collection (inside and outside). No flashes, tripods or video cameras allowed inside the museum. Photography is not permitted of special exhibition works of art displayed throughout the museum.

THE DAYTON ART INSTITUTE

Art Changes Lives **Live it**

LOWER LEVEL GALLERIES



- 101 African Art
- 102 Pre-Columbian Art
- 103 Oceanic Art
- 104 Southeast Asian Art
- 105-107 Japanese Art
- 108 Korean Art
- 109 Asian Art
- 110-113 Chinese Art
- 114 Tibetan Art
- 115 Indian Art
- 116-118 Shaw Collection of Pre-Columbian Art
- 117 Virginia W. Kettering Gallery
- 118 James M. Cox Gallery
- 123 Eileen Dicke Gallery of Glass
- 124 Experiencenter
- 125-126 South Gallery
- 127 North Gallery
- 128 North Gallery-Native American Art

- ♿** REST ROOMS
- E** ELEVATOR
- ♿** WHEELCHAIR ACCESS

MUSEUM HOURS

Open Wednesday-Saturday from 10:00 a.m. to 5:00 p.m., Sunday noon to 5:00 p.m. with extended hours on Thursday until 8:00 p.m. Closed Monday, Tuesday and major holidays.

www.daytonartinstitute.org
937-223-4ART